



For each problem the right solution.

For Chemicals

Drum pumps with mechanical seal		
	Applications	PP for aggressive liquids e.g. acids, caustics, vegetable oils, paints ... PVDF highly aggressive liquids like concentrated or mixed acids, ... SS acids, caustics, fruit-juices, milk, paints, thin-bodied oils, ... HC highly aggressive liquids like concentrated or heated acids and solvents, ...
	Pump tubes	tube: polypropylene (PP), polyvinylidene fluoride (PVDF), stainless steel (SS) or Hastelloy C4 (HC) seal: mechanical seal immersion depth: 700, 1000, 1200 mm and special immersion depth
	Drive motors	electrical: p310 = 520 Watt, 230 Volt / 50 Hz, 115 Volt / 60 Hz, p400 = 850 Watt, 230 Volt / 50 Hz, 115 Volt / 60 Hz, d370 = 370 Watt at 6 bar air pressure pneumatical:
	Performance	delivery rate max. 175 l/min delivery head max. 22 metres water column viscosity max. 1000 Centipoise

For inflammable liquids

Explosion-proof drum pumps in stainless steel and HC		
	Applications	SS inflammable liquids according to VbF HC highly aggressive and inflammable liquids
	Pump tubes	tube: stainless steel (SS) or Hastelloy C4 (HC) seal: mechanical seal immersion depth: 700, 1000, 1200 mm and special immersion depth
	Drive motors	electrical: ex300 = 420 Watt, 230 Volt / 50 Hz, 115 Volt / 60 Hz, pneumatical: d370 = 370 Watt at 6 bar air pressure
	Performance	delivery rate max. 140 l/min delivery head max. 16 metres water column viscosity max. 400 Centipoise

For small discharge flows

Laboratory pumps in PP or stainless steel		
	Applications	PP for aggressive liquids e.g. acids, caustics, vegetable oils, paints, galvanic liquids, ... SS acids, caustics, fruit-juices, milk, ...
	Pump tubes	tube: polypropylene (PP) or stainless steel (SS) seal: sealless immersion depth: 650, 900 mm and special immersion depth
	Drive motor	electrical: 200 Watt, 230 Volt / 50 Hz
	Performance	delivery rate max. 70 l/min delivery head max. 7 metres water column viscosity max. 500 Centipoise

For aggressive liquids

Sealless drum pumps		
	Applications	PP for aggressive liquids e.g. acids, caustics, vegetable oils, paints ... PVDF highly aggressive liquids like concentrated or mixed acids, ... SS acids, caustics, fruit-juices, milk, paints, thin-bodied oils, ... HC highly aggressive liquids like concentrated or heated acids and solvents, ...
	Pump tubes	tube: polypropylene (PP), polyvinylidene fluoride (PVDF), stainless steel (SS) or Hastelloy C4 (HC) seal: sealless immersion depth: 700, 1000, 1200 mm and special immersion depth
	Drive motors	electrical: p310 = 520 Watt, 230 Volt / 50 Hz, 115 Volt / 60 Hz, p400 = 850 Watt, 230 Volt / 50 Hz, 115 Volt / 60 Hz, d370 = 370 Watt at 6 bar air pressure pneumatical:
	Performance	delivery rate max. 110 l/min delivery head max. 20 metres water column viscosity max. 700 Centipoise

For mixed liquids

Mixing drum pumps in PP and stainless steel		
	Applications	PP aggressive emulsions, dispersions and suspensions SS paints and lacquers and other mixed and inflammable liquids
	Pump tubes	tube: polypropylene (PP) or stainless steel (SS) seal: mechanical seal immersion depth: 700, 1000, 1200 mm and special immersion depth
	Drive motors	electrical: p310 = 520 Watt, 230 Volt / 50 Hz, 115 Volt / 60 Hz, p400 = 850 Watt, 230 Volt / 50 Hz, 115 Volt / 60 Hz, ex300 = 420 Watt, 230 Volt / 50 Hz, 115 Volt / 60 Hz, d370 = 370 Watt at 6 bar air pressure explosion-proofed: pneumatical:
	Performance	delivery rate max. 145 l/min delivery head max. 15 metres water column viscosity max. 1000 Centipoise

For medium-viscosity liquids

Feed-screw drum pumps in PP und stainless steel		
	Applications	PP aggressive medium-viscosity liquids and paints, vegetable oils, cosmetics, ... SS paints, lacquers, fruit-juices, oils, vegetable oils, cosmetics, foods, ...
	Pump tubes	tube: polypropylene (PP) or stainless steel (SS) seal: mechanical seal / sealless immersion depth: 700, 1000, 1200 mm and special immersion depth
	Drive motors	electrical: p310 = 520 Watt, 230 Volt / 50 Hz, 115 Volt / 60 Hz, (universal motor) p400 = 850 Watt, 230 Volt / 50 Hz, 115 Volt / 60 Hz, (universal motor) pd500 = 0,18 kW, single 230 V / 50 Hz or three-phase 400 V / 50 Hz,
	Performance	delivery rate max. 115 l/min delivery head max. 12 metres water column viscosity max. 6000 Centipoise

For toxic liquids

Drum pumps with magnetic coupling		
	Applications	suitable for pumping toxic, gaseous and hazardous liquids due to being hermetically sealed with no leakage
	Pump tubes	tube: polypropylene (PP), polyvinylidene fluoride (PVDF), stainless steel (SS) or Hastelloy C4 (HC) immersion depth: 700, 1000, 1200 mm and special immersion depth
	Drive motors	electrical: p310 = 520 Watt, 230 Volt / 50 Hz, 115 Volt / 60 Hz, p400 = 850 Watt, 230 Volt / 50 Hz, 115 Volt / 60 Hz, d370 = 370 Watt at 6 bar air pressure pneumatical:
	Performance	delivery rate max. 175 l/min delivery head max. 22 metres water column viscosity max. 50 Centipoise

For complete drum emptying

Complete-drainage drum pump in PP and stainless steel		
	Applications	PP for aggressive liquids e.g. acids, caustics, vegetable oils, paints, galvanic liquids, ... Niro acids, caustics, fruit-juices, milk, paints, thin-bodied oils, ...
	Pump tubes	tube: polypropylene (PP) or stainless steel (SS) seal: mechanical seal immersion depth: 700, 1000, 1200 mm and special immersion depth
	Drive motors	electrical: p310 = 520 Watt, 230 Volt / 50 Hz, 115 Volt / 60 Hz, p400 = 850 Watt, 230 Volt / 50 Hz, 115 Volt / 60 Hz, d370 = 370 Watt at 6 bar air pressure pneumatical:
	Performance	delivery rate max. 90 l/min delivery head max. 16 metres water column viscosity max. 1000 Centipoise

For high-viscosity liquids

Eccentric screw drum pumps in stainless steel		
	Applications	for pumping high-viscosity liquids e.g. resin, paints, lacquers, glue, oil, soap, shampoo, ointment, honey, sirup, tomato paste, fruit concentrate, molasse, glucose, ...
	Pump tubes	tube: stainless steel (SS) stators: NBR, NBR-light, FPM, PTFE seal: mechanical seal or packing gland immersion depth: 1000 mm and special immersion depth
	Drive motors	with and without quick release coupling electrical: 0,37 – 1,5 kW, 700 or 900 rpm, 400 Volt / 50 Hz pneumatical: 0,5 – 1,1 kW, up to 1000 rpm at 6 bar air pressure
	Performance	delivery rate max. 60 l/min delivery head max. 12 bar viscosity max. 100.000 Centipoise

Advantages of grün-drum pumps

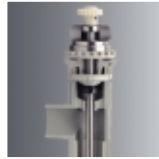

mechanical seal

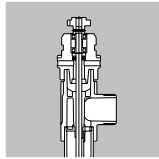

sealless

- **no inner-tube**
- easily accessible shaft
- easy to clean
- solid shaft
- mechanical seal

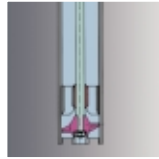

singlestage design



multistage design

- **singlestage design**
- big discharge flows
- **multistage design**
- lower noise
- more stages possible, gives more pressure



feed-screw

- **with feed-screw**
- for medium-viscous liquids
- smooth pumping of liquids
- low noise with three-phase motor
- high performance with universal motor

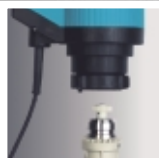

quick release coupling

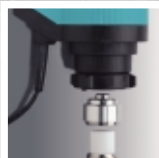

magnetic coupling

- **quick release coupling**
- speedy connection
- robust design
- rugged bow-gear coupling
- suitable for aggressive environments

- **magnetic coupling**
- hermetically sealed
- for gaseous and hazardous liquids
- no leakage



quick release coupling



rigid connection

- **Eccentric screw barrel pump with quick release coupling**
- removable drive motor
- easy and safe handling with the separate pump tube
- no lifting device necessary
- it's possible to drive several pump tubes with only one motor

- **rigid connection** of drive motor and pump tube

DRUM PUMPS

FOR EACH LIQUID
THE RIGHT DRUM PUMP

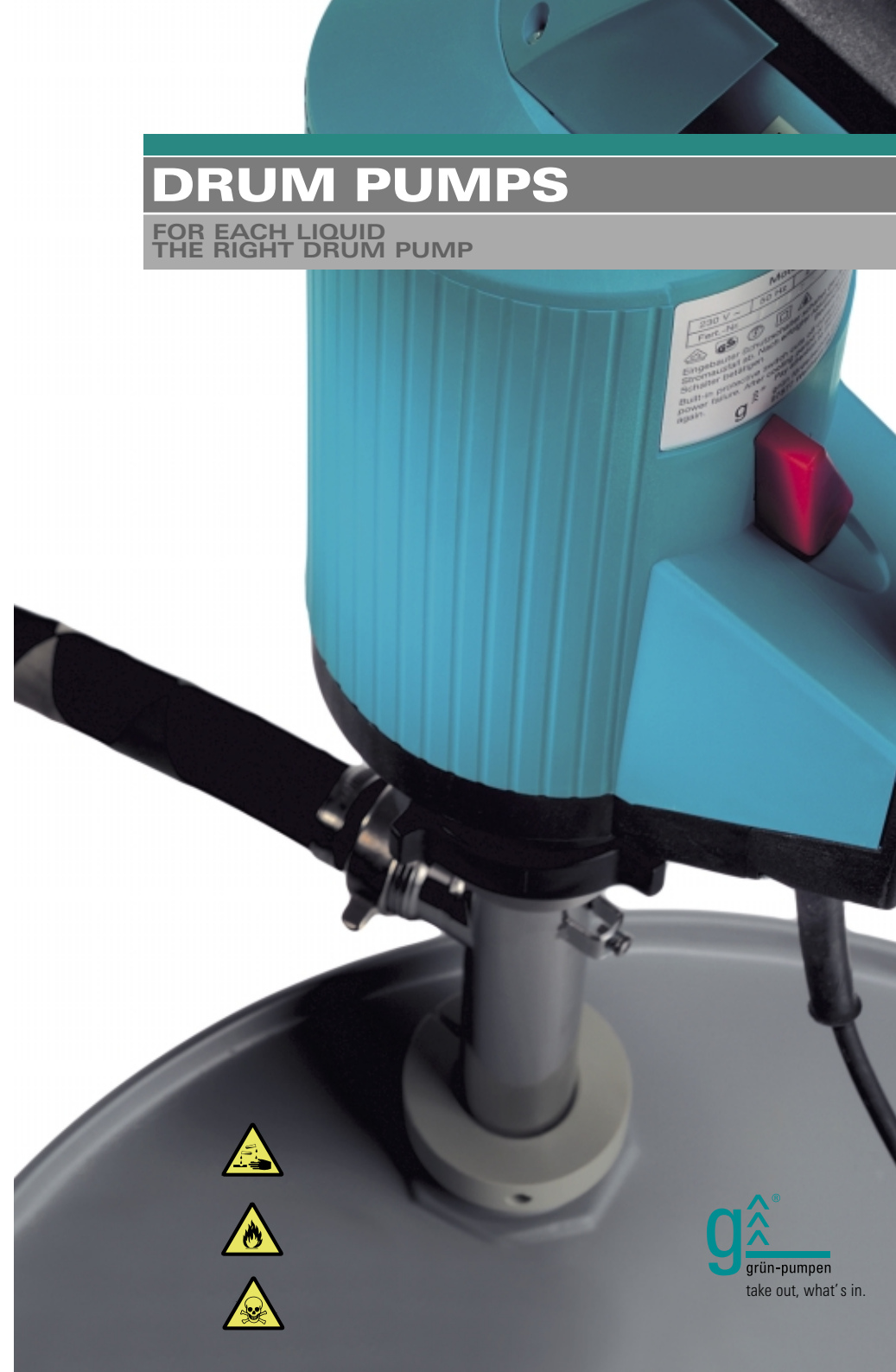

Accessories

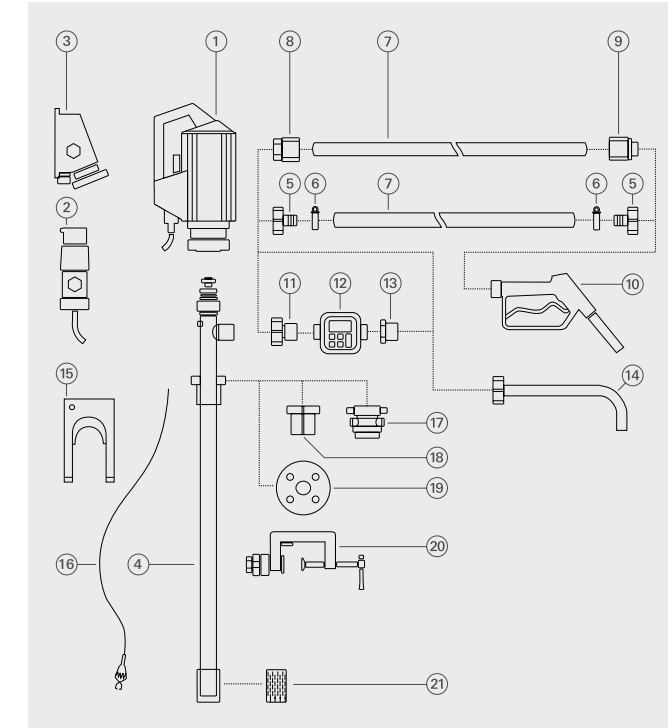

- 1 Drive motor
- 2 Explosion-proof plug
- 3 Explosion-proof socket
- 4 Pump tube
- 5 Hose connector
- 6 Hose clamps
- 7 Hose
- 8 Hose fittings
- 9 Hose fittings
- 10 Nozzle
- 11 Flow meter connection
- 12 Flow meter
- 13 Reducing piece
- 14 Discharge spout
- 15 Wall bracket
- 16 Equipotential bounding cable
- 17 Emission proof drum adapter
- 18 Drum adapter
- 19 Installation flange
- 20 Clamping device
- 21 Foot strainer

Represented by:

grün-pumpen gmbh
 Zum Ottersberg 12
 D-97877 Wertheim-Reicholzheim
 Telefon +49 09342/3 08-761
 Telefax +49 09342/3 08-790
 info@gruen-pumpen.de
 www.gruen-pumpen.de

